



Procedure for Removing, Cleaning and Re-installing Sample Chambers

Removal

1. Remove dust cover and sensor assembly cover to expose sample chamber assembly.
2. Remove the electrical connect by pulling the connector away from the sensor assembly. Do not use the wires to pull, hold the connector firmly and pull away from the sensor assembly.
3. Loosen and remove the two 6-32x2" screws that fasten the sample chamber to the upper chassis.
4. Remove the Tygon tubing on both the inlet and outlet of the sample chamber. To remove the tubing on the outlet, simply pull the sample chamber up and away from the upper chassis.

Cleaning

1. Place the sample chamber on a level surface with the sensor assembly facing up.
2. Loosen the two 6-32x3/4" screws and turn the supporting clamps to free the sensor assembly.
3. Remove the sensor assembly either by lifting straight up or by sliding it out.
4. Holding the sample chamber in one hand, use a small screwdriver or pen and insert into the aperture opening at an angle. Push inward until the rear window is dislodged. Try not to push the screwdriver through the hole in the aperture strip. This will cause damage to both the aperture strip and the rear window.
5. Remove and separate the aperture strip and rear window. Note: some application may not have a aperture strip.
6. Use an acceptable cleaner like isopropyl alcohol to clean the sample chamber, aperture strip and rear window. Ensure that the opening of the sample chamber is free from any lint.

Reassembly

1. Place the sample chamber on a level surface with the clamps facing up.
2. Before inserting the aperture strip, ensure that the manufacture approve silicon grease is applied to both ends of the aperture strip. Apply a small drop on each end so that there is enough to cover the ends of the aperture strip but not too much or it will plug any of the flow paths. Insert aperture strip with the grease side down.
3. Inspect and replace any defective gasket that may have been damage during the removal of the rear window. Place the gasket into the slot provided after removing any plastic coating.

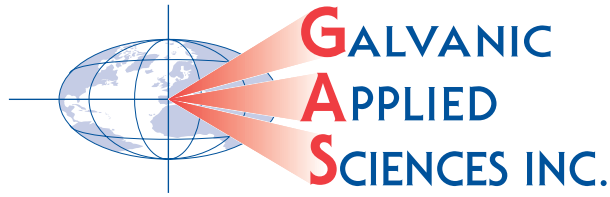

Procedure for Removing, Cleaning and Re-installing Sample Chambers

4. Place the rear window on top of the gasket ensuring a tight fit. The window once installed should not slide out of the slot.
5. Replace the sensor assembly by sliding it into the sample chamber or by dropping it straight in to place.
6. Twist the support clamps into place and tighten. Inspect the fit to ensure that the sensor assembly is flush with the sample chamber.
7. Replace the sample chamber assembly and insert the two 6-32-2" screws and tighten.
8. Reattach the Tygon tubing to both the inlet and outlet of the sample chamber.
9. Reconnect the electrical connector to the sensor assembly ensuring that the red wire side of the connector is inserted to P1 on the sensor assembly.
10. Check for leaks

ASSEMBLY:

1. Sample chamber
2. Aperture
3. Rear window
4. Sensor assembly
5. Gasket
6. Support clamps

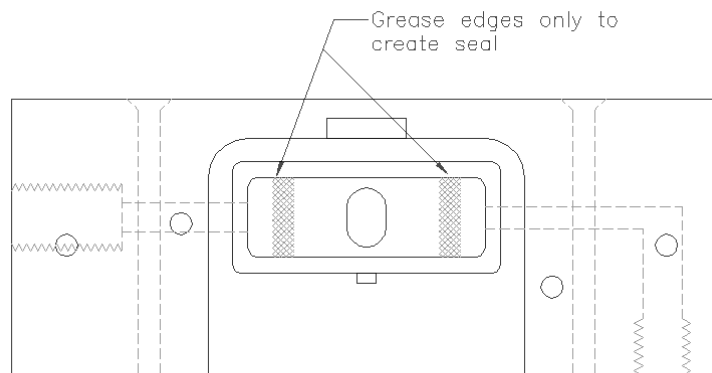
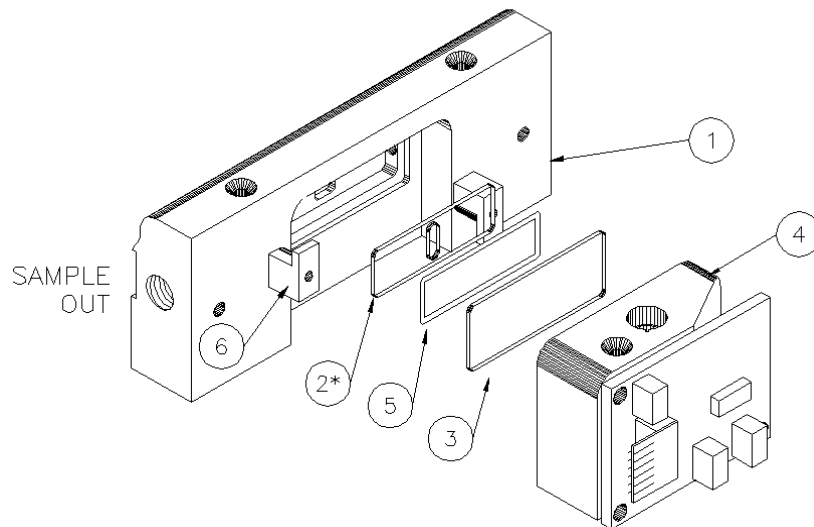

Rear View